



Lapro Surge[®]



Endo Pouch

Automatic Specimen Retrieval Bag Range

A comprehensive range of high quality retrieval bags with rigid deployment device

Endo Pouch

The Endo Pouch automatic retrieval bag is manufactured from polyurethane for a durable and tear-resistant high quality specimen retrieval bag. The bags are one-piece manufactured with heat sealed seams, avoiding any serrations and weak points.

The bags are available in four sizes to cover specimen retrieval across a wide range of laparoscopic procedures; from the Mini bag deployed through a 5mm port up to the Extra Large bag deployed through a 15mm port, all bags are introduced using a user-friendly deployment device for quick and simple specimen retrieval.

The Endo Pouch opens automatically in the abdominal cavity and is held open by rigid wire arms during tissue capture. The strong arms enable the device to be used to rotate the bag and to scoop to assist with specimen capture.

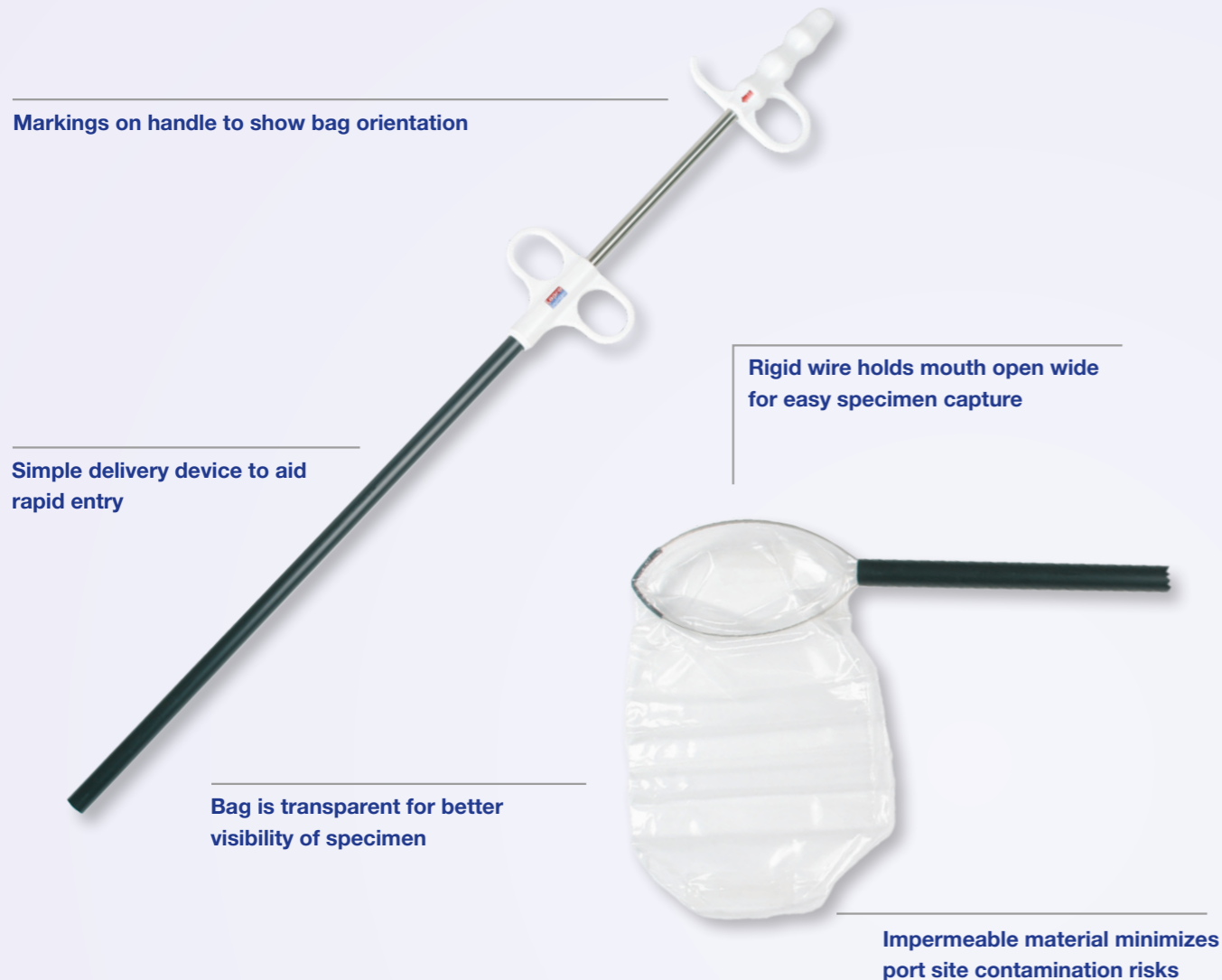

The Endo Pouch is available in both detachable and non-detachable options depending on user preference and application:

- The non-detachable bag option provides the advantage of multiple use during the same procedure. Users may also make use of the additional strength provided by the deployment device during extraction of the specimen through the incision.
- The detachable bag option requires the deployment device to be removed following tissue capture, enabling the separated bag to be set aside and removed upon completion of the laparoscopic procedure.

Detachable Endo Pouch



- The Detachable Endo Pouch is inserted into the abdominal cavity using the deployment device and is held open by rigid wire arms.
- Following specimen capture, the bag is closed fully for specimen security using the strong nylon purse string.
- The bag must be separated from the delivery device with two quick movements to enable the deployment device to be removed first from the port.
- Once the inner tube has been removed, an airtight seal on the outer tube of the deployment device prevents loss of pneumoperitoneum prior to removal of the second part.
- Following removal of the delivery device, the detached retrieval bag can be set aside and removed from the abdominal cavity at any point through an appropriate sized incision, allowing flexibility during the laparoscopic procedure.

Product	Ordering Code	Volume	Dimensions	Trocar Diameter	Box Qty
Small Endo Pouch	RB002	255ml	100mm x 160mm	10mm/12mm	10
Medium/Large Endo Pouch	RB004	680ml	150mm x 180mm	10mm/12mm	10
Extra Large Endo Pouch	RB006	1500ml	190mm x 230mm	15mm	5
Extra Large Endo Pouch	RB008	1500ml	190mm x 230mm	12mm	5

Non-Detachable Endo Pouch

- The Non-Detachable Endo Pouch is inserted into the abdominal cavity through the deployment device and is held open by rigid wire arms.
- The bag stays attached to the deployment device to enable the bag to be closed and reopened, allowing multiple use during the same laparoscopic procedure.
- The bag is closed by pulling the inner tube of the delivery device prior to removal.
- The bag can also be reopened for intra-abdominal aspiration of bag contents prior to specimen removal.
- The rigid delivery device provides additional strength during extraction of the bag from the abdominal cavity.



Product	Ordering Code	Volume	Dimensions	Trocar Diameter	Box Qty
Small Endo Pouch	RB001	255ml	100mm x 160mm	10mm/12mm	10
Medium/Large Endo Pouch	RB003	680ml	150mm x 180mm	10mm/12mm	10

NEW Detachable Mini Endo Pouch

For deployment through a 5mm port

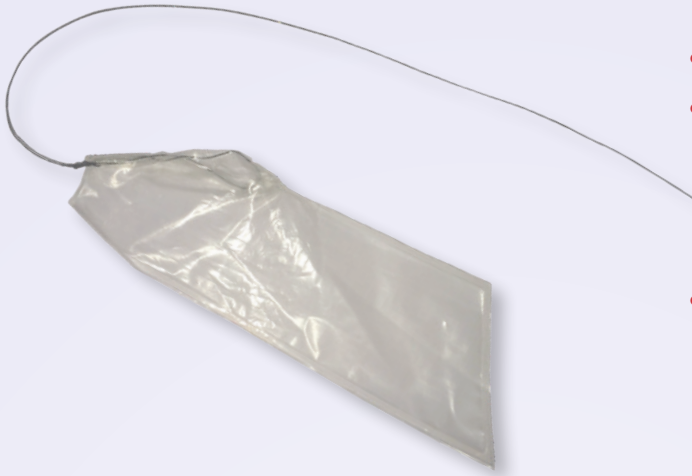

- Impressive volume compared with incision size
- The innovative design allows for delivery through a 5mm port and enables surgeons to achieve greater clinical benefits for the appropriate procedure using the same traditional techniques without an additional larger sized port
- The Mini Endo Pouch opens automatically and expands lengthwise along the same direction as grasping instruments for ease of use

Product	Ordering Code	Volume	Dimensions	Trocar Diameter	Box Qty
Mini Endo Pouch	MRB002	120ml	165mm x 60mm	5mm	5

NEW Tapered Endo Pouch

New tapered bag design for easier removal of gall bladders



Product	Ordering Code	Volume	Dimensions	Trocar Diameter	Box Qty
Non Detachable Endo Pouch	RB001-T	200ml	100mm x 160mm	10/12mm	10
Detachable Endo Pouch	RB002-T	200ml	100mm x 160mm	10/12mm	10



Lapro Surge

For more information visit our website or contact us:

Tel: +44 (0)1923 220 711 **Fax:** +44 (0)20 8950 8659 **E-mail:** info@laprosurge.com

www.laprosurge.com

APPROVED 10/2017